

**THANK YOU FOR YOUR INTEREST IN OUR PRODUCTS**

Please use this equipment carefully and observe all warnings and cautions.

\*\*\*\*\*NOTE\*\*\*\*\*

<b>WEAR</b>	protective clothing and eyewear when dispensing chemicals or other materials.
<b>ALWAYS</b>	observe safety and handling instructions of the chemical manufacturers.
<b>ALWAYS</b>	direct discharge away from you or other persons or into approved containers.
<b>ALWAYS</b>	dispense cleaners and chemicals in accordance with manufacturer's instructions. Exercise CAUTION when maintaining your equipment.
<b>KEEP</b>	equipment clean to maintain proper operation.
<b>WEAR</b>	protective clothing and eyewear when working in the vicinity of all chemicals, filling or emptying equipment.
<b>ALWAYS</b>	re-assemble equipment according to instruction procedures. Be sure all components are firmly screwed or latched into position.
<b>ATTACH</b>	only to tap water outlets (85 PSI maximum).
<b>NOTE</b>	If the unit is used to fill a sink or the discharge hose can be placed into a sink, the unit must be mounted so that the bottom of the cabinet is above the overflow rim of the sink.

**Installation & Operation:**

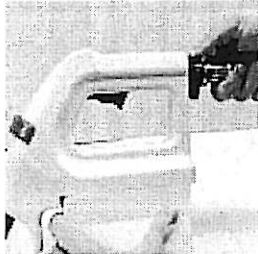

1. Connect water supply hose of 1/2" ID to water inlet swivel. Min. 20 PSI pressure is required for proper operation. Connect opposite end of hose to water supply. Turn water supply on.

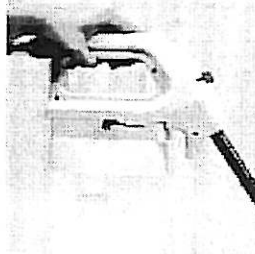

2. Insert product container into shroud until it locks into place.

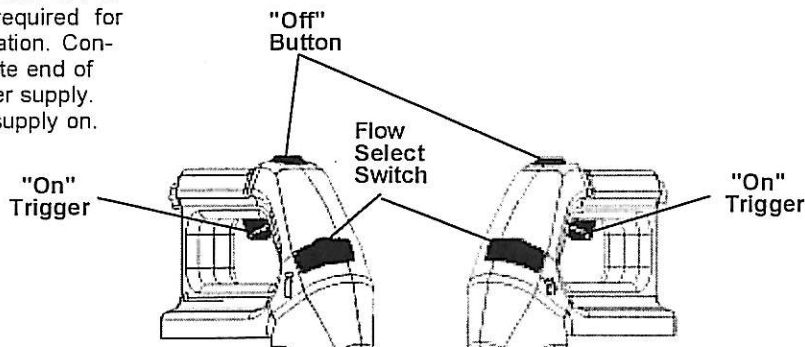
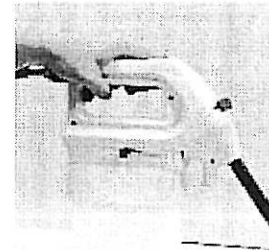

3a. Slide flow select switch towards bottle icon for low flow then depress trigger to begin dispensing desired concentrate solution; push "Off" button on top of handle to stop flow of solution.



3b. Slide flow select switch towards bucket icon for high flow then depress trigger to begin dispensing desired concentrate solution; push "Off" button on top of handle to stop flow of solution.

**Installation & Operation continued:**

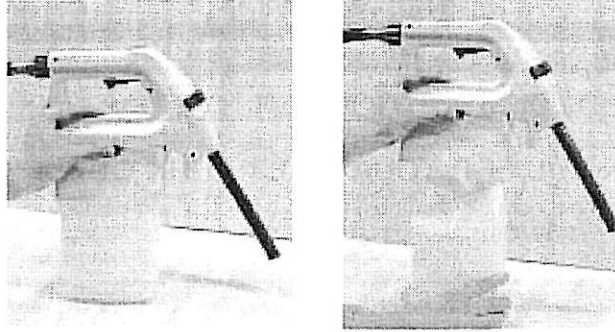

4. To remove chemical concentrate container, place hand securely under the empty product, slide release lever to the right and pull concentrate container out.

**Parts Diagram:**

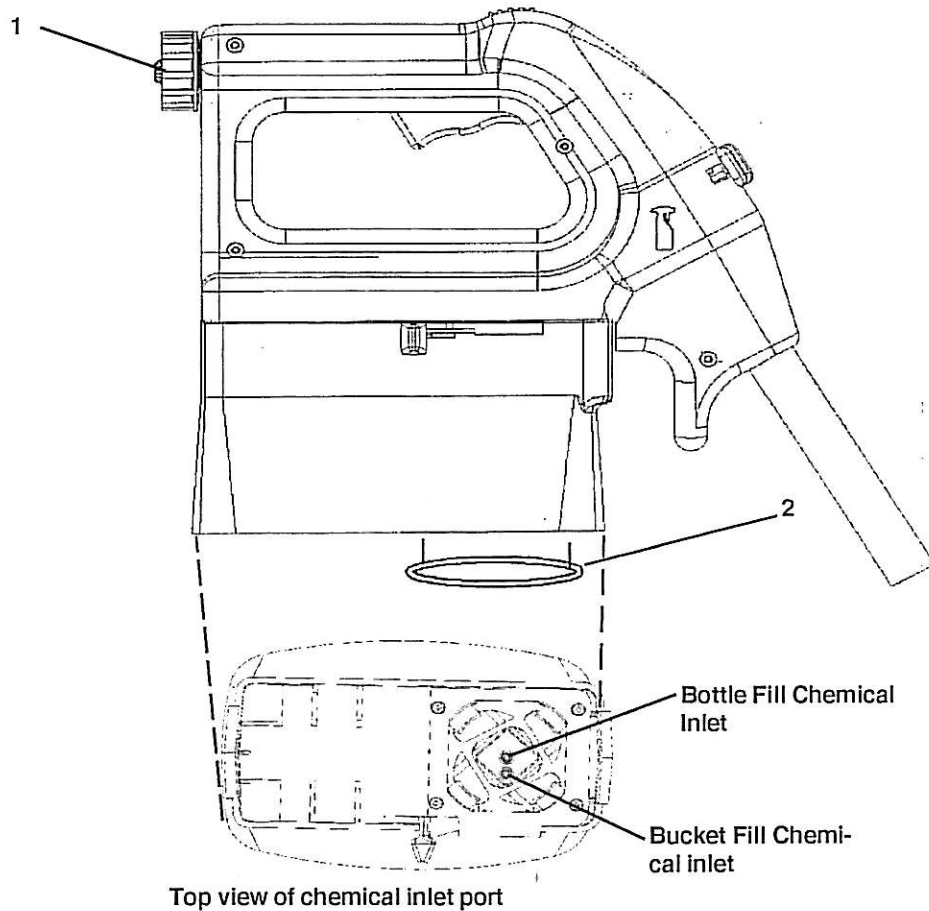

Key	Part No.	Description
-----	----------	-------------

1	238100	Strainer washer
2	10089916	Bottle release ring

Not shown:

10091920	Water inlet hose, 3/8" x 6'
10058010	Coupler, GH x male quick-connect
671000	Coupler, GH x female quick-connect

## TROUBLESHOOTING CHART:

Problem	Cause	Solution
1. No discharge	<ul style="list-style-type: none"> <li>a. No water</li> <li>b. Excessive water pressure</li> <li>c. Clogged water inlet strainer</li> </ul>	<ul style="list-style-type: none"> <li>a. Open water supply</li> <li>b. Install regulator if flowing water pressure exceeds 80 PSI</li> <li>c. Disconnect inlet water line and clean strainer</li> </ul>
2. No concentrate draw	<ul style="list-style-type: none"> <li>a. Low water pressure</li> <li>b. Concentrate container empty</li> <li>c. Concentrate container not properly installed</li> </ul>	<ul style="list-style-type: none"> <li>a. Minimum 20 PSI (with water running) required to operate unit properly</li> <li>b. Replace with full container</li> <li>c. Remove and install Concentrate container</li> </ul>
3. Foaming in discharge	<ul style="list-style-type: none"> <li>a. Concentrate container in unit malfunctioning or not installed properly</li> </ul>	<ul style="list-style-type: none"> <li>a. Remove and reinstall Concentrate container or Replace with new concentrate container</li> </ul>
4. Failure of unit to turn off	<ul style="list-style-type: none"> <li>a. Excessive water pressure</li> </ul>	<ul style="list-style-type: none"> <li>a. Install regulator if pressure (with water flowing) exceeds 80 PSI</li> </ul>
5. Unit is too hard to turn turn on	<ul style="list-style-type: none"> <li>a. Excessive water pressure</li> </ul>	<ul style="list-style-type: none"> <li>a. Install regulator if pressure (with water flowing) exceeds 80 PSI</li> </ul>



**e.mix**

DILUTION CONTROL SYSTEM



**ChemBlend**  
INTERNATIONAL

SEATTLE • LOS ANGELES • HOUSTON • ADAMS • CHICAGO • BOSTON • MONTREAL

866.201.1218

